

VAN BUREN STATE PARK

COVERT TWP.

COVERT TOWNSHIP

HIGH RISK EROSION AREAS & CRITICAL DUNE AREAS

VAN BUREN COUNTY

T2S,R17W

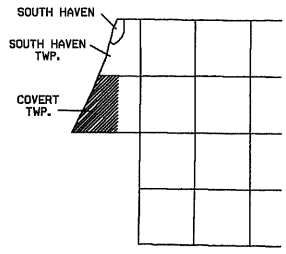

HIGH RISK EROSION AREAS

THE NUMBER REPRESENTS, IN FEET, THE 60' 30 YEAR PROJECTED RECESSION DISTANCE.
 THE NUMBER REPRESENTS, IN FEET, THE 60 YEAR PROJECTED RECESSION DISTANCE.

HIGH RISK EROSION AREA (shading alongshore)

THESE AREAS ARE LEGALLY DEFINED BY PART 323, SHORELANDS PROTECTION AND MANAGEMENT, OF THE NATURAL RESOURCE & ENVIRONMENTAL PROTECTION ACT 1994 PA 451 BEING GREAT LAKES SHORELAND AREAS DOCUMENTED TO REcede AN AVERAGE OF ONE FOOT OR MORE PER YEAR.

CRITICAL DUNE AREAS

BARRIER DUNES
 BARRIER DUNE FORMATIONS DESIGNATED PURSUANT TO PART 353, SAND DUNE PROTECTION & MANAGEMENT, OF THE NATURAL RESOURCE & ENVIRONMENTAL PROTECTION ACT 1994 PA 451.

AREAS NOT INCLUDED IN DESIGNATED BARRIER DUNE FORMATIONS THAT ARE COMPOSED PRIMARILY OF DUNE SAND AND EXHIBIT SEVERAL DUNE-LIKE CHARACTERISTICS.

EXEMPLARY DUNE ASSOCIATED PLANT COMMUNITIES OUTSIDE DESIGNATED DUNE FORMATIONS. MICHIGAN NATURAL FEATURES INVENTORY REFERENCE CODE INDICATED.

SOURCE

STATE OF MICHIGAN RECESSION RATE MAPS & ATLAS OF CRITICAL DUNE AREAS

INFORMATION

MICHIGAN DEPARTMENT OF ENVIRONMENTAL QUALITY
 LAND AND WATER MANAGEMENT DIVISION
 P.O. BOX 30458
 LANSING, MI 48998-9758
 (517) 373-1958



GREAT LAKES INFORMATION SYSTEM
 MICHIGAN DEPARTMENT OF NATURAL RESOURCES
 LAND AND WATER MANAGEMENT DIVISION

06-15-94
 Amended 02-29-96

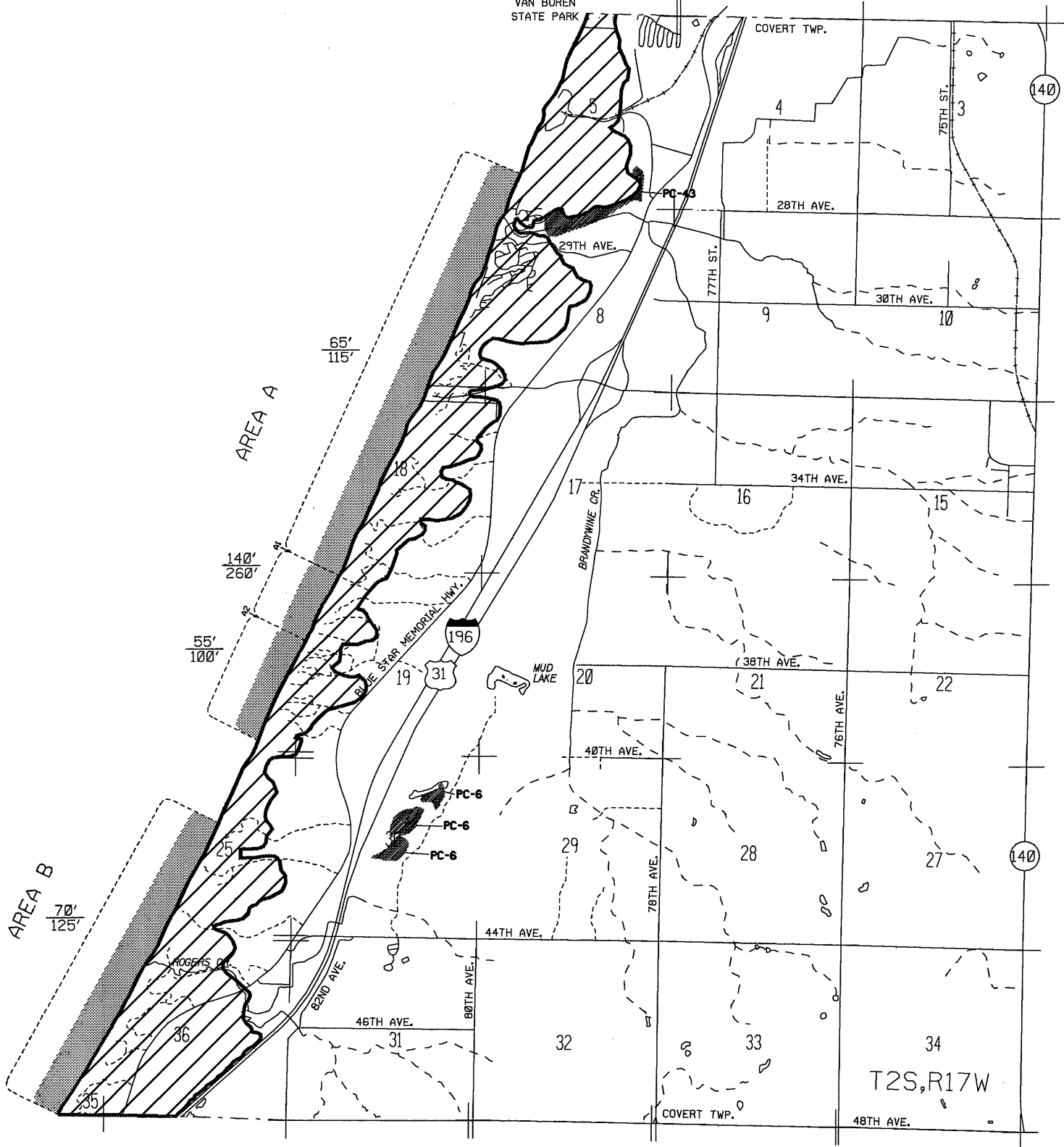
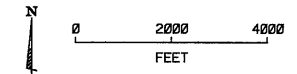

T2S,R17W

48TH AVE.

Parcels in High Risk Erosion Areas of Covert Township, Van Buren County

HREAs identified North to South Date of Designation: November 18, 1994

| HREA* | Sequence No. | Parcel Identification Number | Rate (feet/year) | 30 yr PRD* | 60 yr PRD* |
|-------|--------------|---|------------------|------------|------------|
| A1 | 1 | 80-07-005-002-00 Entenergy Palisades | 1.7 | 65 | 115 |
| A1 | 2 | 80-07-005-002-00 | 1.7 | 65 | 115 |
| A1 | 3 | 80-07-005-002-00 | 1.7 | 65 | 115 |
| A1 | 4 | 80-07-005-002-00 | 1.7 | 65 | 115 |
| A1 | 5 | 80-07-Vacant Lot | 1.7 | 65 | 115 |
| A1 | 6 | 80-07-222-004-00 | 1.7 | 65 | 115 |
| A1 | 7 | 80-07-222-020-00 | 1.7 | 65 | 115 |
| A1 | 8 | 80-07-222-001-00 | 1.7 | 65 | 115 |
| A1 | 9 | 80-07-221-015-00 | 1.7 | 65 | 115 |
| A1 | 10 | 80-07-221-010-00 | 1.7 | 65 | 115 |
| A1 | 11 | 80-07-221-002-00 | 1.7 | 65 | 115 |
| A1 | 12 | 80-07-221-002-50 | 1.7 | 65 | 115 |
| A1 | 13 | 80-07-471-010-00 | 1.7 | 65 | 115 |
| A1 | 14 | 80-07-474-001-01 | 1.7 | 65 | 115 |
| A1 | 15 | 80-07-474-002-00 | 1.7 | 65 | 115 |
| A1 | 16 | 80-07-401-001-00 | 1.7 | 65 | 115 |
| A1 | 17 | 80-07-402-009-00 | 1.7 | 65 | 115 |
| A1 | 17.2 | 80-07-402-019-00 | 1.7 | 65 | 115 |
| A1 | 18 | 80-07-402-008-00 | 1.7 | 65 | 115 |

HREA* - Some parcels may be in multiple HREAs due to their large size.

30 yr PRD* is the Projected Recession Distance (feet) landward from the Erosion Hazard Line for readily moveable structures including those structures 3,500 square feet or less and built on a basement, crawlspace or pilings. Additional restrictions may apply per Administrative Rules 281.21-22.

60 yr PRD* is the Projected Recession Distance (feet) landward from the Erosion Hazard Line for non-readily moveable structures such as large structures and septic systems.

Designation runs with the land including subsequent splits. Absence of a property number does not guarantee the property is located outside of an HREA. Contact the Great Lakes Shorelands Unit, Water Resources Division, DEQ in Lansing or the local DEQ field office for assistance.

Parcels in High Risk Erosion Areas of Covert Township, Van Buren County

HREAs identified North to South Date of Designation: November 18, 1994

| HREA* | Sequence No. | Parcel Identification Number | Rate (feet/year) | 30 yr PRD* | 60 yr PRD* |
|-------|--------------|------------------------------|------------------|------------|------------|
| A1 | 18.2 | 80-07-402-018-00 | 1.7 | 65 | 115 |
| A1 | 19 | 80-07-402-006-01 | 1.7 | 65 | 115 |
| A1 | 19.2 | 80-07-402-017-00 | 1.7 | 65 | 115 |
| A1 | 19.21 | 80-07-402-014-00 | 1.7 | 65 | 115 |
| A1 | 20 | 80-07-402-005-00 | 1.7 | 65 | 115 |
| A1 | 20.2 | 80-07-402-015-00 | 1.7 | 65 | 115 |
| A1 | 21 | 80-07-402-004-00 | 1.7 | 65 | 115 |
| A1 | 21.2 | 80-07-402-002-00 | 1.7 | 65 | 115 |
| A1 | 22 | 80-07-402-003-00 | 1.7 | 65 | 115 |
| A1 | 23 | 80-07-402-001-00 | 1.7 | 65 | 115 |
| A1 | 24 | 80-07-402-002-10 | 1.7 | 65 | 115 |
| A1 | 25 | 80-07-Ravine Way | 1.7 | 65 | 115 |
| A1 | 26 | 80-07-403-003-00 | 1.7 | 65 | 115 |
| A1 | 26.2 | 80-07-403-002-00 | 1.7 | 65 | 115 |
| A1 | 26.21 | 80-07-403-016-00 | 1.7 | 65 | 115 |
| A1 | 26.3 | 80-07-403-001-00 | 1.7 | 65 | 115 |
| A1 | 27 | 80-07-403-005-00 | 1.7 | 65 | 115 |
| A1 | 27.2 | 80-07-403-015-00 | 1.7 | 65 | 115 |
| A1 | 28 | 80-07-403-004-00 | 1.7 | 65 | 115 |

HREA* - Some parcels may be in multiple HREAs due to their large size.

30 yr PRD* is the Projected Recession Distance (feet) landward from the Erosion Hazard Line for readily moveable structures including those structures 3,500 square feet or less and built on a basement, crawlspace or pilings. Additional restrictions may apply per Administrative Rules 281.21-22.

60 yr PRD* is the Projected Recession Distance (feet) landward from the Erosion Hazard Line for non-readily moveable structures such as large structures and septic systems.

Designation runs with the land including subsequent splits. Absence of a property number does not guarantee the property is located outside of an HREA. Contact the Great Lakes Shorelands Unit, Water Resources Division, DEQ in Lansing or the local DEQ field office for assistance.

Parcels in High Risk Erosion Areas of Covert Township, Van Buren County

HREAs identified North to South Date of Designation: November 18, 1994

| HREA* | Sequence No. | Parcel Identification Number | Rate (feet/year) | 30 yr PRD* | 60 yr PRD* |
|-------|--------------|------------------------------|------------------|------------|------------|
| A1 | 29 | 80-07-403-007-00 | 1.7 | 65 | 115 |
| A1 | 29.2 | 80-07-403-011-00 | 1.7 | 65 | 115 |
| A1 | 30 | 80-07-403-013-00 | 1.7 | 65 | 115 |
| A1 | 31 | 80-07-403-010-50 | 1.7 | 65 | 115 |
| A1 | 32 | 80-07-403-010-00 | 1.7 | 65 | 115 |
| A1 | 33 | 80-07-Palisades Drive | 1.7 | 65 | 115 |
| A1 | 34 | 80-07-431-001-00 | 1.7 | 65 | 115 |
| A1 | 34 | 80-07-453-001-01 | 1.7 | 65 | 115 |
| A1 | 35 | 80-07-431-002-00 | 1.7 | 65 | 115 |
| A1 | 36 | 80-07-500-018-00 | 1.7 | 65 | 115 |
| A1 | 37 | 80-07-500-017-00 | 1.7 | 65 | 115 |
| A1 | 38 | 80-07-500-015-00 | 1.7 | 65 | 115 |
| A1 | 39 | 80-07-500-014-00 | 1.7 | 65 | 115 |
| A1 | 40 | 80-07-500-013-00 | 1.7 | 65 | 115 |
| A1 | 41 | 80-07-500-012-00 | 1.7 | 65 | 115 |
| A1 | 42 | 80-07-500-011-00 | 1.7 | 65 | 115 |
| A1 | 43 | 80-07-500-010-00 | 1.7 | 65 | 115 |
| A1 | 44 | 80-07-500-009-00 | 1.7 | 65 | 115 |
| A1 | 45 | 80-07-500-007-00 | 1.7 | 65 | 115 |

HREA* - Some parcels may be in multiple HREAs due to their large size.

30 yr PRD* is the Projected Recession Distance (feet) landward from the Erosion Hazard Line for readily moveable structures including those structures 3,500 square feet or less and built on a basement, crawlspace or pilings. Additional restrictions may apply per Administrative Rules 281.21-22.

60 yr PRD* is the Projected Recession Distance (feet) landward from the Erosion Hazard Line for non-readily moveable structures such as large structures and septic systems.

Designation runs with the land including subsequent splits. Absence of a property number does not guarantee the property is located outside of an HREA. Contact the Great Lakes Shorelands Unit, Water Resources Division, DEQ in Lansing or the local DEQ field office for assistance.

Parcels in High Risk Erosion Areas of Covert Township, Van Buren County

HREAs identified North to South Date of Designation: November 18, 1994

| HREA* | Sequence No. | Parcel Identification Number | Rate (feet/year) | 30 yr PRD* | 60 yr PRD* |
|-------|--------------|------------------------------|------------------|------------|------------|
| A1 | 46 | 80-07-500-006-00 | 1.7 | 65 | 115 |
| A1 | 47 | 80-07-500-005-00 | 1.7 | 65 | 115 |
| A1 | 48 | 80-07-500-004-00 | 1.7 | 65 | 115 |
| A1 | 49 | 80-07-500-003-00 | 1.7 | 65 | 115 |
| A1 | 50 | 80-07-500-002-00 | 1.7 | 65 | 115 |
| A1 | 50.1 | 80-07-999-802-30 | 1.7 | 65 | 115 |
| A1 | 51 | 80-07-500-001-00 | 1.7 | 65 | 115 |
| A1 | 52 | 80-07-182-006-00 | 1.7 | 65 | 115 |
| A1 | 52.2 | 80-07-182-007-00 | 1.7 | 65 | 115 |
| A1 | 53 | 80-07-182-015-01 | 1.7 | 65 | 115 |
| A1 | 54 | 80-07-182-002-10 | 1.7 | 65 | 115 |
| A1 | 54.2 | 80-07-182-012-00 | 1.7 | 65 | 115 |
| A1 | 55 | 80-07-182-001-00 | 1.7 | 65 | 115 |
| A1 | 55.01 | 80-07-181-031-00 | 1.7 | 65 | 115 |
| A1 | 56 | 80-07-181-030-01 | 1.7 | 65 | 115 |
| A1 | 57 | 80-07-181-005-00 | 1.7 | 65 | 115 |
| A1 | 57.2 | 80-07-181-014-00 | 1.7 | 65 | 115 |
| A1 | 58 | 80-07-181-001-00 | 1.7 | 65 | 115 |
| A1 | 58.2 | 80-07-181-017-00 | 1.7 | 65 | 115 |

HREA* - Some parcels may be in multiple HREAs due to their large size.

30 yr PRD* is the Projected Recession Distance (feet) landward from the Erosion Hazard Line for readily moveable structures including those structures 3,500 square feet or less and built on a basement, crawlspace or pilings. Additional restrictions may apply per Administrative Rules 281.21-22.

60 yr PRD* is the Projected Recession Distance (feet) landward from the Erosion Hazard Line for non-readily moveable structures such as large structures and septic systems.

Designation runs with the land including subsequent splits. Absence of a property number does not guarantee the property is located outside of an HREA. Contact the Great Lakes Shorelands Unit, Water Resources Division, DEQ in Lansing or the local DEQ field office for assistance.

Parcels in High Risk Erosion Areas of Covert Township, Van Buren County

HREAs identified North to South Date of Designation: November 18, 1994

| HREA* | Sequence No. | Parcel Identification Number | Rate (feet/year) | 30 yr PRD* | 60 yr PRD* |
|-------|--------------|------------------------------|------------------|------------|------------|
| A1 | 59 | 80-07-183-100-01 | 1.7 | 65 | 115 |
| A1 | 60 | 80-07-017-026-00 | 1.7 | 65 | 115 |
| A1 | 61 | 80-07-017-027-00 | 1.7 | 65 | 115 |
| A1 | 62 | 80-07-017-025-00 | 1.7 | 65 | 115 |
| A1 | 63 | 80-07-017-028-00 | 1.7 | 65 | 115 |
| A1 | 64 | 80-07-017-024-00 | 1.7 | 65 | 115 |
| A1 | 65 | 80-07-017-029-00 | 1.7 | 65 | 115 |
| A1 | 66 | 80-07-017-030-00 | 1.7 | 65 | 115 |
| A1 | 67 | 80-07-017-031-00 | 1.7 | 65 | 115 |
| A1 | 68 | 80-07-017-032-00 | 1.7 | 65 | 115 |
| A1 | 69 | 80-07-017-033-00 | 1.7 | 65 | 115 |
| A1 | 70 | 80-07-017-034-00 | 1.7 | 65 | 115 |
| A1 | 71 | 80-07-017-035-00 | 1.7 | 65 | 115 |
| A1 | 72 | 80-07-017-036-10 | 1.7 | 65 | 115 |
| A1 | 73 | 80-07-017-036-01 | 1.7 | 65 | 115 |
| A1 | 74 | 80-07-017-037-00 | 1.7 | 65 | 115 |
| A1 | 75 | 80-07-017-038-00 | 1.7 | 65 | 115 |
| A1 | 76 | 80-07-017-039-00 | 1.7 | 65 | 115 |
| A1 | 77 | 80-07-017-040-00 | 1.7 | 65 | 115 |

HREA* - Some parcels may be in multiple HREAs due to their large size.

30 yr PRD* is the Projected Recession Distance (feet) landward from the Erosion Hazard Line for readily moveable structures including those structures 3,500 square feet or less and built on a basement, crawlspace or pilings. Additional restrictions may apply per Administrative Rules 281.21-22.

60 yr PRD* is the Projected Recession Distance (feet) landward from the Erosion Hazard Line for non-readily moveable structures such as large structures and septic systems.

Designation runs with the land including subsequent splits. Absence of a property number does not guarantee the property is located outside of an HREA. Contact the Great Lakes Shorelands Unit, Water Resources Division, DEQ in Lansing or the local DEQ field office for assistance.

Parcels in High Risk Erosion Areas of Covert Township, Van Buren County

HREAs identified North to South Date of Designation: November 18, 1994

| HREA* | Sequence No. | Parcel Identification Number | Rate (feet/year) | 30 yr PRD* | 60 yr PRD* |
|-------|--------------|------------------------------|------------------|------------|------------|
| A1 | 78 | 80-07-017-041-02 | 1.7 | 65 | 115 |
| A1 | 79 | 80-07-017-042-02 | 1.7 | 65 | 115 |
| A1 | 80 | 80-07-018-001-00 | 1.7 | 65 | 115 |
| A1 | 81 | 80-07-018-003-00 | 1.7 | 65 | 115 |
| A1 | 82 | 80-07-018-002-00 | 1.7 | 65 | 115 |
| A1 | 83 | 80-07-018-004-00 | 1.7 | 65 | 115 |
| A1 | 84 | 80-07-018-005-00 | 1.7 | 65 | 115 |
| A1 | 85 | 80-07-018-006-00 | 1.7 | 65 | 115 |
| A1 | 86 | 80-07-018-007-02 | 1.7 | 65 | 115 |
| A1 | 87 | 80-07-018-007-21 | 1.7 | 65 | 115 |
| A1 | 89 | 80-07-018-008-01 | 1.7 | 65 | 115 |
| A2 | 90 | 80-07-019-001-00 | 4.1 | 140 | 260 |
| A2 | 91 | 80-07-019-002-00 | 4.1 | 140 | 260 |
| A2 | 92 | 80-07-019-005-00 | 4.1 | 140 | 260 |
| A2 | 93 | 80-07-019-003-00 | 4.1 | 140 | 260 |
| A2 | 94 | 80-07-019-004-00 | 4.1 | 140 | 260 |
| A2 | 95 | 80-07-019-006-00 | 4.1 | 140 | 260 |
| A2 | 96 | 80-07-019-007-00 | 4.1 | 140 | 260 |
| A2 | 97 | 80-07-019-009-00 | 4.1 | 140 | 260 |

HREA* - Some parcels may be in multiple HREAs due to their large size.

30 yr PRD* is the Projected Recession Distance (feet) landward from the Erosion Hazard Line for readily moveable structures including those structures 3,500 square feet or less and built on a basement, crawlspace or pilings. Additional restrictions may apply per Administrative Rules 281.21-22.

60 yr PRD* is the Projected Recession Distance (feet) landward from the Erosion Hazard Line for non-readily moveable structures such as large structures and septic systems.

Designation runs with the land including subsequent splits. Absence of a property number does not guarantee the property is located outside of an HREA. Contact the Great Lakes Shorelands Unit, Water Resources Division, DEQ in Lansing or the local DEQ field office for assistance.

Parcels in High Risk Erosion Areas of Covert Township, Van Buren County

HREAs identified North to South Date of Designation: November 18, 1994

| HREA* | Sequence No. | Parcel Identification Number | Rate (feet/year) | 30 yr PRD* | 60 yr PRD* |
|-------|--------------|------------------------------|------------------|------------|------------|
| A2 | 98 | 80-07-019-010-00 | 4.1 | 140 | 260 |
| A2 | 99 | 80-07-019-013-00 | 4.1 | 140 | 260 |
| A2 | 100 | 80-07-019-011-00 | 4.1 | 140 | 260 |
| A2 | 101 | 80-07-019-012-00 | 4.1 | 140 | 260 |
| A3 | 102 | 80-07-019-016-00 | 1.4 | 55 | 100 |
| A3 | 103 | 80-07-019-017-00 | 1.4 | 55 | 100 |
| A3 | 104 | 80-07-019-018-00 | 1.4 | 55 | 100 |
| A3 | 105 | 80-07-019-019-00 | 1.4 | 55 | 100 |
| A3 | 106 | 80-07-019-020-00 | 1.4 | 55 | 100 |
| A3 | 107 | 80-07-019-021-00 | 1.4 | 55 | 100 |
| A3 | 108 | 80-07-019-022-00 | 1.4 | 55 | 100 |
| A3 | 109 | 80-07-019-023-00 | 1.4 | 55 | 100 |
| A3 | 110 | 80-07-019-024-00 | 1.4 | 55 | 100 |
| A3 | 111 | 80-07-019-025-00 | 1.4 | 55 | 100 |
| A3 | 112 | 80-07-570-001-00 | 1.4 | 55 | 100 |
| A3 | 113 | 80-07-570-002-00 | 1.4 | 55 | 100 |
| A3 | 114 | 80-07-570-003-00 | 1.4 | 55 | 100 |
| B1 | 115 | 80-07-075-008-00 | 1.8 | 70 | 125 |
| B1 | 116 | 80-07-075-012-02 | 1.8 | 70 | 125 |

HREA* - Some parcels may be in multiple HREAs due to their large size.

30 yr PRD* is the Projected Recession Distance (feet) landward from the Erosion Hazard Line for readily moveable structures including those structures 3,500 square feet or less and built on a basement, crawlspace or pilings. Additional restrictions may apply per Administrative Rules 281.21-22.

60 yr PRD* is the Projected Recession Distance (feet) landward from the Erosion Hazard Line for non-readily moveable structures such as large structures and septic systems.

Designation runs with the land including subsequent splits. Absence of a property number does not guarantee the property is located outside of an HREA. Contact the Great Lakes Shorelands Unit, Water Resources Division, DEQ in Lansing or the local DEQ field office for assistance.

Parcels in High Risk Erosion Areas of Covert Township, Van Buren County

HREAs identified North to South Date of Designation: November 18, 1994

| HREA* | Sequence No. | Parcel Identification Number | Rate (feet/year) | 30 yr PRD* | 60 yr PRD* |
|-------|--------------|------------------------------|------------------|------------|------------|
| B1 | 117 | 80-07-075-012-10 | 1.8 | 70 | 125 |
| B1 | 118 | 80-07-019-028-00 | 1.8 | 70 | 125 |
| B1 | 119 | 80-07-075-010-00 | 1.8 | 70 | 125 |
| B1 | 120 | 80-07-075-009-00 | 1.8 | 70 | 125 |
| B1 | 121 | 80-07-075-004-00 | 1.8 | 70 | 125 |
| B1 | 123 | 80-07-075-002-32 | 1.8 | 70 | 125 |
| B1 | 124 | 80-07-075-002-40 | 1.8 | 70 | 125 |
| B1 | 125 | 80-07-075-002-11 | 1.8 | 70 | 125 |
| B1 | 126 | 80-07-075-002-20 | 1.8 | 70 | 125 |
| B1 | 127 | 80-07-100-112-25 | 1.8 | 70 | 125 |
| B1 | 128 | 80-07-100-112-50 | 1.8 | 70 | 125 |
| B1 | 129 | 80-07-100-112-75 | 1.8 | 70 | 125 |
| B1 | 130 | 80-07-100-112-00 | 1.8 | 70 | 125 |
| B1 | 131 | 80-07-100-020-00 | 1.8 | 70 | 125 |
| B1 | 132 | 80-07-100-019-00 | 1.8 | 70 | 125 |
| B1 | 133 | 80-07-100-018-00 | 1.8 | 70 | 125 |
| B1 | 134 | 80-07-100-017-00 | 1.8 | 70 | 125 |
| B1 | 135 | 80-07-100-016-00 | 1.8 | 70 | 125 |
| B1 | 136 | 80-07-100-015-00 | 1.8 | 70 | 125 |

HREA* - Some parcels may be in multiple HREAs due to their large size.

30 yr PRD* is the Projected Recession Distance (feet) landward from the Erosion Hazard Line for readily moveable structures including those structures 3,500 square feet or less and built on a basement, crawlspace or pilings. Additional restrictions may apply per Administrative Rules 281.21-22.

60 yr PRD* is the Projected Recession Distance (feet) landward from the Erosion Hazard Line for non-readily moveable structures such as large structures and septic systems.

Designation runs with the land including subsequent splits. Absence of a property number does not guarantee the property is located outside of an HREA. Contact the Great Lakes Shorelands Unit, Water Resources Division, DEQ in Lansing or the local DEQ field office for assistance.

Parcels in High Risk Erosion Areas of Covert Township, Van Buren County

HREAs identified North to South Date of Designation: November 18, 1994

| HREA* | Sequence No. | Parcel Identification Number | Rate (feet/year) | 30 yr PRD* | 60 yr PRD* |
|-------|--------------|------------------------------|------------------|------------|------------|
| B1 | 137 | 80-07-100-014-00 | 1.8 | 70 | 125 |
| B1 | 138 | 80-07-100-013-00 | 1.8 | 70 | 125 |
| B1 | 139 | 80-07-100-011-00 | 1.8 | 70 | 125 |
| B1 | 140 | 80-07-100-010-00 | 1.8 | 70 | 125 |
| B1 | 141 | 80-07-100-009-00 | 1.8 | 70 | 125 |
| B1 | 142 | 80-07-100-008-50 | 1.8 | 70 | 125 |
| B1 | 143 | 80-07-100-007-00 | 1.8 | 70 | 125 |
| B1 | 144 | 80-07-100-006-00 | 1.8 | 70 | 125 |
| B1 | 145 | 80-07-100-005-00 | 1.8 | 70 | 125 |
| B1 | 146 | 80-07-100-004-00 | 1.8 | 70 | 125 |
| B1 | 147 | 80-07-100-003-00 | 1.8 | 70 | 125 |
| B1 | 148 | 80-07-100-002-00 | 1.8 | 70 | 125 |
| B1 | 149 | 80-07-100-001-00 | 1.8 | 70 | 125 |
| B1 | 150 | 80-07-200-001-03 | 1.8 | 70 | 125 |
| B1 | 152 | 80-07-200-001-20 | 1.8 | 70 | 125 |
| B1 | 153 | 80-07-200-004-00 | 1.8 | 70 | 125 |
| B1 | 154 | 80-07-200-006-00 | 1.8 | 70 | 125 |
| B1 | 155 | 80-07-200-007-00 | 1.8 | 70 | 125 |
| B1 | 156 | 80-07-200-009-00 | 1.8 | 70 | 125 |

HREA* - Some parcels may be in multiple HREAs due to their large size.

30 yr PRD* is the Projected Recession Distance (feet) landward from the Erosion Hazard Line for readily moveable structures including those structures 3,500 square feet or less and built on a basement, crawlspace or pilings. Additional restrictions may apply per Administrative Rules 281.21-22.

60 yr PRD* is the Projected Recession Distance (feet) landward from the Erosion Hazard Line for non-readily moveable structures such as large structures and septic systems.

Designation runs with the land including subsequent splits. Absence of a property number does not guarantee the property is located outside of an HREA. Contact the Great Lakes Shorelands Unit, Water Resources Division, DEQ in Lansing or the local DEQ field office for assistance.

Parcels in High Risk Erosion Areas of Covert Township, Van Buren County

HREAs identified North to South Date of Designation: November 18, 1994

| HREA* | Sequence No. | Parcel Identification Number | Rate (feet/year) | 30 yr PRD* | 60 yr PRD* |
|-------|--------------|------------------------------|------------------|------------|------------|
| B1 | 157 | 80-07-200-010-00 | 1.8 | 70 | 125 |
| B1 | 158 | 80-07-200-011-00 | 1.8 | 70 | 125 |
| B1 | 159 | 80-07-200-012-00 | 1.8 | 70 | 125 |
| B1 | 160 | 80-07-200-013-00 | 1.8 | 70 | 125 |
| B1 | 161 | 80-07-200-014-50 | 1.8 | 70 | 125 |
| B1 | 162 | 80-07-200-015-00 | 1.8 | 70 | 125 |
| B1 | 163 | 80-07-200-017-50 | 1.8 | 70 | 125 |
| B1 | 164 | 80-07-200-017-00 | 1.8 | 70 | 125 |
| B1 | 165 | 80-07-200-018-51 | 1.8 | 70 | 125 |
| B1 | 166 | 80-07-200-019-01 | 1.8 | 70 | 125 |
| B1 | 167 | 80-07-200-002-00 | 1.8 | 70 | 125 |
| B1 | 168 | 80-07-200-002-10 | 1.8 | 70 | 125 |
| B1 | 169 | 80-07-200-022-01 | 1.8 | 70 | 125 |
| B1 | 170 | 80-07-200-024-00 | 1.8 | 70 | 125 |
| B1 | 171 | 80-07-200-026-00 | 1.8 | 70 | 125 |
| B1 | 172 | 80-07-200-027-10 | 1.8 | 70 | 125 |
| B1 | 173 | 80-07-200-027-52 | 1.8 | 70 | 125 |

HREA* - Some parcels may be in multiple HREAs due to their large size.

30 yr PRD* is the Projected Recession Distance (feet) landward from the Erosion Hazard Line for readily moveable structures including those structures 3,500 square feet or less and built on a basement, crawlspace or pilings. Additional restrictions may apply per Administrative Rules 281.21-22.

60 yr PRD* is the Projected Recession Distance (feet) landward from the Erosion Hazard Line for non-readily moveable structures such as large structures and septic systems.

Designation runs with the land including subsequent splits. Absence of a property number does not guarantee the property is located outside of an HREA. Contact the Great Lakes Shorelands Unit, Water Resources Division, DEQ in Lansing or the local DEQ field office for assistance.